

BBQGUYS[™]
SIGNATURE

Luxury Stone Outdoor Kitchens



Assembly Instructions

Assembly Instructions

IMPORTANT SAFETY INFORMATION

- For your safety, always wear proper personal protective equipment such as gloves and safety glasses when working with this product. We have included them in your tool kit.
- Stone vents have been installed for you based on your specific layout. Do not block, remove, or alter these vents as they are critical to ensure your safety and protect from explosion.
- These assembly instructions are not meant to supersede or replace local, state, and/or federal codes. It is the owners responsibility to understand and comply with all codes.

EACH ORDER CONTAINS ALL THE HARDWARE REQUIRED

Introduction

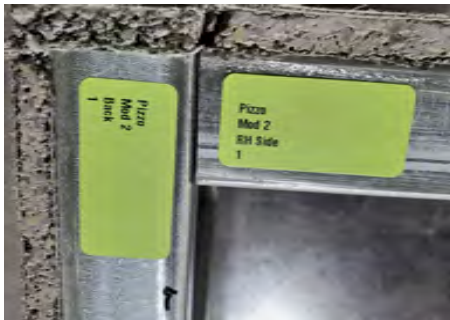


Figure 1

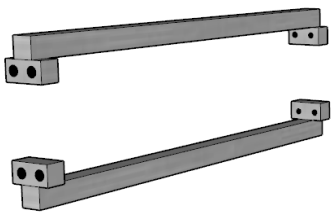
- Line 1: Client's name
- Line 2: What module the panel goes to
- Line 3: Location of panel
- Line 4: For plant use

Part Identification

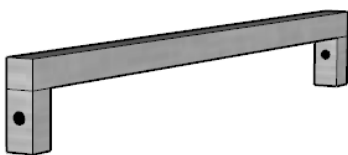


Figure 2

- There are orange stickers on all parts as well as corresponding stickers on the panels
- Match letter on sticker with letter on panel or other parts



Module Connectors: Used To Join Modules And Panels Together As Well As Support For Floors And Countertops.



Supports: Used To Join Panels Together Front To Back As Well As Support For Countertops.



1/4" Washer - Used with the 1/4" hex bolt to connect module panels together and attach a module to another module.



1/4" Hex bolt - Used to connect module panels together and attach a module to another module.



Sheet Metal Screw - Used to attach doors and drawers.

****Important Note: All Your Appliance And Storage Cutouts Have Been Made For You. You Simply Assemble The Panels As Shown In This Manual, No Cutting Needed.**

Step 1

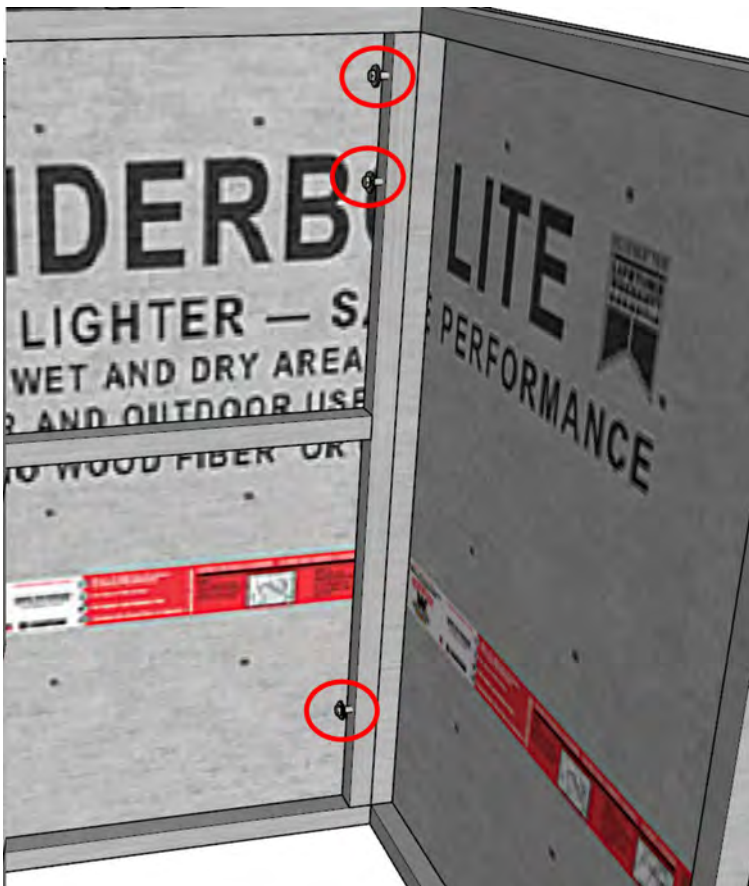


Assemble Back And Side

Step 1A

- Stand back panel and side panel up as shown in figure 4

Figure 4



Step 1B

- Attach side panel to back panel using (3) hex bolts and (3) washers as shown in figure 5
- Ensure side panel and front panel are flush on top and sides, tighten the bolts fully using the included 7/16" wrench

Figure 5

Step 2

Assemble Module 2 Back And Side

Step 2A

- Assemble module 2 back and side in the same manner as step 1
- Slide module 2 back and side together with module 1 back and side as shown in figure 6
- No hardware required at this step

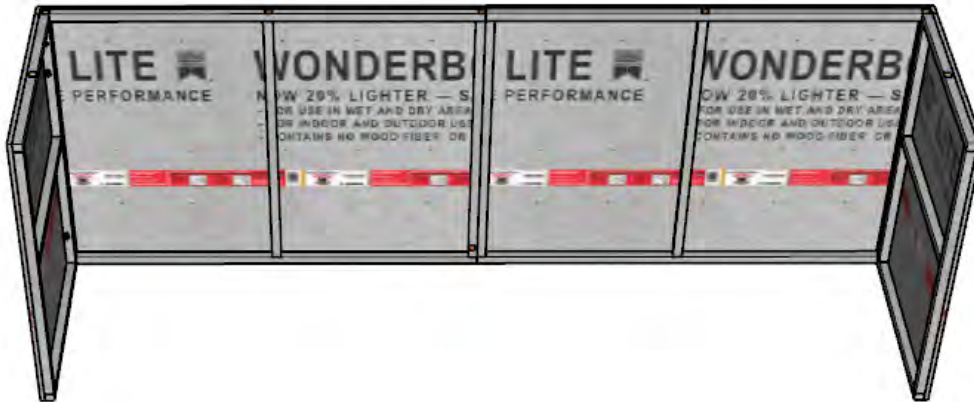


Figure 6

Step 3

Assemble Module 1 Front

Step 3

- Place module 1 front on as shown in figure 7
- Attach side panel to back panel using (3) hex bolts and (3) washers as shown in figure 5
- Ensure side panel and front panel are flush on top and sides, tighten the bolts fully using the



Figure 7



Figure 8

Install Module Connectors

Step 3A

- Locate module connectors by matching the orange stickers
- Attach connectors as shown in figure 8 to join the back panel of module 1 and module 2, as well as the front panel of module 1
- Attach side panel to back panel using (3) hex bolts and (3) washers as shown in figure 5
- Ensure side panel and front panel are flush on top and sides, tighten the bolts fully using the included 7/16" wrench
- All other module connectors are assembled in the same manner

Install Floors

Step 3B

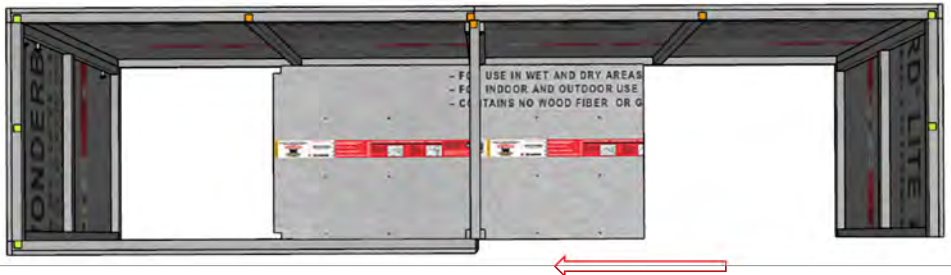


Figure 9

- Insert module 1 floor as shown in figure 9
- Floor simply rests upon the supports, no hardware is required

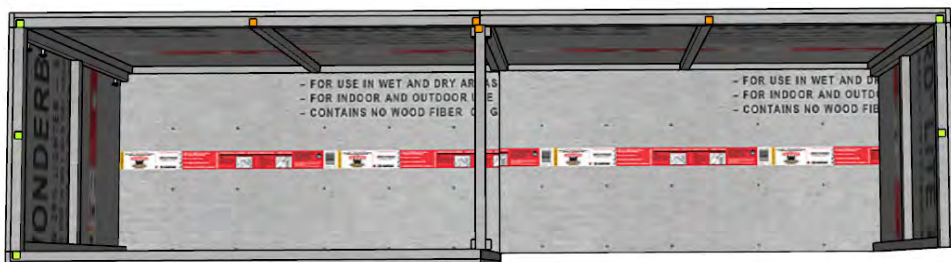


Figure 10

- Insert module 2 floor as shown in figure 10

Step 4

Attach Module 2 Front

Step 4A

- Attach module 2 front panel to side panel using (3) hex bolts and (3) washers as shown in figure 5
- Ensure side panel and front panel are flush on top and sides, tighten the bolts fully using the included 7/16" wrench
- Now attach module 2 front panel and module connectors using (2) hex bolts and (2) washers as shown in figure 8
- Ensure side panel and front panel are flush on top and sides, tighten the bolts fully using the included 7/16" wrench

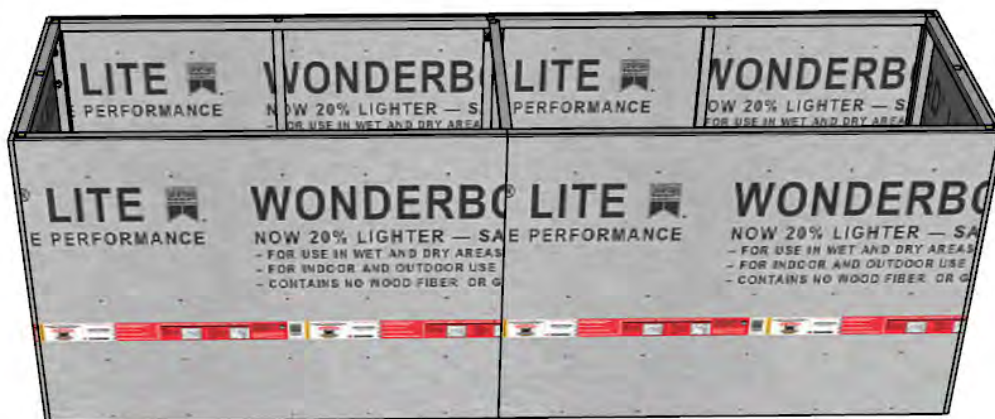


Figure 10



Figure 11

Install Countertop

Step 4B

- Keeping countertop face up, place it carefully on the steel frame of the outdoor kitchen base as shown in Fig 11.
- Using bolts and washers, run bolts through openings in the base frame into the countertop.
- If you have more than one countertop piece, carefully join them together and ensure they are straight and the only a small gap exists between them.
- Once countertop pieces are in place, ensure they are flush to each other (if you have more than 1) and tighten the bolts. Do not over tighten, they just need to be snug.



Install Appliances

- Put doors and drawers in. Drawers and door flanges will sit on top of floors
- Using the included screws, insert a (4) screws into the pre-drilled holes in the door / drawer flanges, (2) on each side top and bottom.
- To make this easier, we have included a drill bit to allow you to pre-drill the holes for the screws into the steel frame.
- Your grill / griddle will simply slide in and sit on top of the granite.

Leveling Modules

- We have made leveling your outdoor kitchen a breeze
- You can adjust the attached leveling feet using the included 3/4" wrench and level to easily level your outdoor kitchen

